

# Industrial Pressure Transmitter

with stainless steel sensor  
Accuracy 0.5% and 0.25%

## Model 3380



### Applications

- Mobile hydraulic, presses
- Development and laboratory
- General mechanical engineering

### Characteristics

- Stainless steel sensor, welded
- Nominal pressure ranges from 0 ... 0.1 bar up to 0 ... 600 bar
- Accuracy according to IEC 60770: 0.5 % FSO  
option 0.25 % FSO



### Technical Data

#### Measuring ranges

Negative	-1...0 bar
Positive	0...0.1 bar up to 0...600 bar
Absolute	0...0.4 bar up to 0...60 bar

#### Measuring accuracy

Deviation from the characteristic curve according to IEC 60770  
– limit point calibration (non-linearity, hysteresis, repeatability):  
≤ ±0.5 % FSO  
(Option: nominal pressure ≥ 0.4 bar ±0.25 % FSO)

#### Overpressure safety

≤ 16 bar at least 4 x FS  
(burst pressure at least 6 x FS)  
≤ 400 bar at least 2.5 x FS  
(burst pressure at least 3 x FS)  
≥ 600 bar at least 1.5 x FS  
(burst pressure at least 3 x FS)

#### Operating temperature range

Medium: -40...125 °C  
Ambient: -40...85 °C  
Storage: -40...100 °C

#### Temperature error band

In compensated range  
-20...85 °C ≤ 0.2 % FSO/10 K

#### Long term stability

≤ ± 0.1 % FSO / year at reference conditions

#### Response time

2-wire: ≤ 10 ms  
3-wire: ≤ 3 ms

#### Process connection

G1/2 A to DIN 3852-E  
options: G1/4, 1/4NPT (others on request)

#### Materials

Housing: Stainless steel 316L (1.4404)  
Pressure port: Stainless steel 316L (1.4404)  
Seal: FKM

#### Supply voltage

2-wire: DC 8...32 V  
3-wire: DC 14...30 V

#### Output signal

4...20 mA, 2-wire  
0...10 V, 3-wire

#### Load

2-wire:  $R_{max} \leq [(U_B - U_{Bmin}) / 0.02 A] \Omega$   $I_{max} < 25 \text{ mA}$   
3-wire:  $R_{max} = 10 \text{ k}\Omega$   $I_{max} < 7 \text{ mA}$

#### Electrical protection

Short circuit proof and protected against reverse polarity

#### Mechanical stability

Vibration: 10 g, 25 Hz...2 kHz DIN EN 60068-2-6  
Shock: 100 g / 11 msec DIN EN 60068-2-27

#### Operational life

100 million load cycles

#### CE-conformity

EMC Directive: 2014/30/EU

**Dimensions in mm**

**Standard**

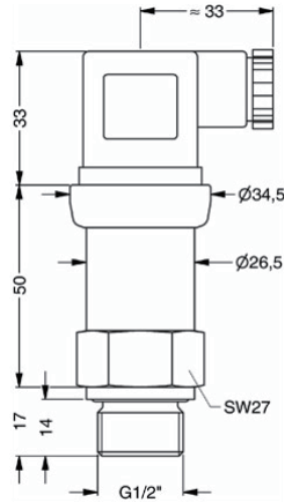

G1/2 DIN 3852

**Process connections**

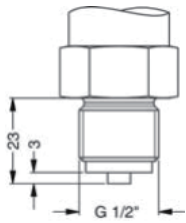

G1/2 EN 837

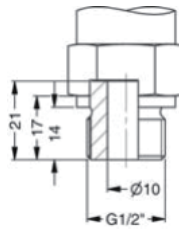

G1/2 DIN 3852

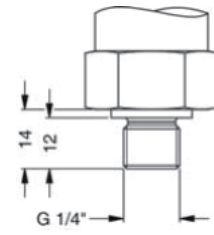

G1/4 DIN 3852

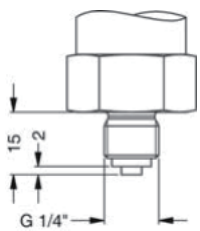

G1/4 EN 837

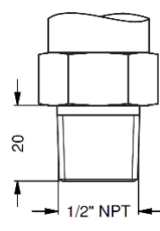

1/2 NPT

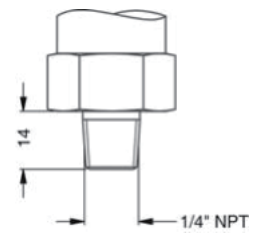

1/4 NPT

## Electrical connection

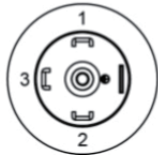
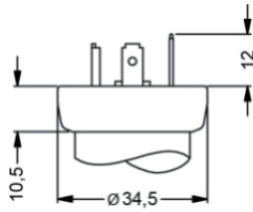

ISO 4400  
(IP65)

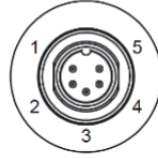
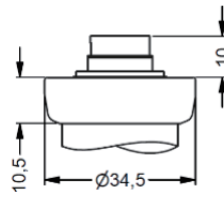

Binder Series 723 5-pin  
(IP67)

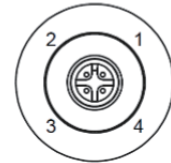
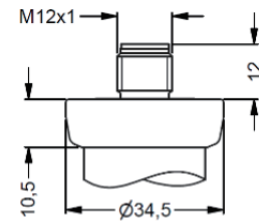

M12x1 4-pin  
(IP67)

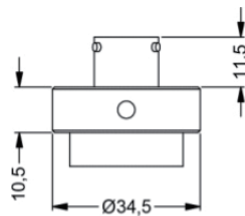

Bayonet MIL-C-26482 (10-6)  
(IP67)

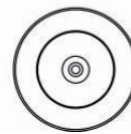
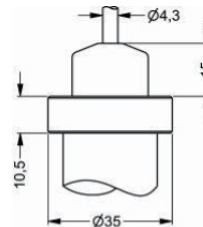

cable outlet with PVC cable  
(IP67)

## Pin configuration

Electrical connection	ISO 4400	Binder 723 (5-pin)	M12x1/metal (4-pin)	Bayonet MIL-C-26482 (10-6)		cable colours (IEC 60757)
				2-wire	3-wire	
Supply +	1	3	1	A	A	WH (white)
Supply -	2	4	2	B	D	BN (brown)
Signal + (for 3-wire)	3	1	3	-	B	GN (green)
Shield	ground pin	5	4	pressure port		GNYE (green-yellow)

## Order details

1. Model
2. Measuring range
3. Output signal
4. Process connection
5. Electrical connection
6. Options